

# COMICA

PROFESSIONAL AUDIO EQUIPMENT

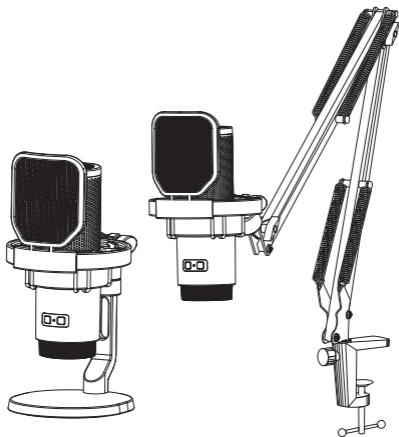

## EJoy Uni Pro

RGB Cardioid Condenser Wireless USB Microphone

User Manual



## Foreword

Thanks for purchasing Comica EJoy Uni Pro

## Main Features

- Groundbreaking Studio Mic with Integrated Wireless Module
- Support Wired/Wireless Dual Modes for Flexible Usage
- 48kHz/24bit Recording, Professional Studio Quality
- Support Gain Control, Monitoring, One-key Denoise & Muting
- Dynamic Radiant RGB Light with 3 Unique RGB Effects
- USB-C Digital Output, Universal for Smartphone/Computer
- Unique Shock-mount and Metal Pop Filter
- Adjustable Boom Arm, Loading Up to 1.5kg —Uni Pro(A)
- Equipped with Desktop Mic Stand, Flexible Extension —Uni Pro(D)

## Notice

- ⚠ Please aim the front of the microphone at the sound source to get an excellent recording.
- ⚠ Do not use this equipment in the vicinity of a heat source or interference source, such as radiator, oven, refrigerator or air conditioner.
- ⚠ This product is a high-precision instrument, please avoid falling, collision or pounding.
- ⚠ Do not use the equipment in rain or in a damp environment to avoid short-circuit danger.
- ⚠ Please store the product in a dry environment.

- ⚠ When connect the mic with computer, please click sound setting and choose "Comica\_EJoy Uni Pro TX" as the output and input device; when connect the receiver with computer, please click sound setting and choose "Comica\_EJoy Uni Pro RX" as the output and input device

When connect the microphone with computer:



When connect the receiver with computer:



- ⚠ If the input sound is too loud when connected to the computer, users can adjust the computer's "Microphone Properties-Level" to reduce the gain(It cannot be adjusted on the Mac OS computer), Take the Windows computer as an example.

When connect the microphone with computer:

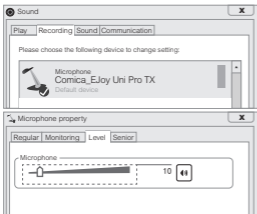

When connect the receiver with computer:

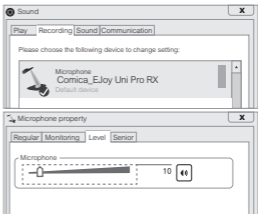

## Packing List

### EJoy Uni Pro(A):

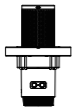

Microphone(TX)\*1



Receiver(RX)\*1



Pop Filter \*1



USB C-USB C/USB A  
2 in 1 Audio Cable \*1



Boom Arm \*1



Hook and Loop  
Fastener \*5



User Manual \*1



Warranty Card \*1

### EJoy Uni Pro(D):

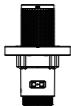

Microphone(TX)\*1



Receiver(RX)\*1



Pop Filter \*1



USB C-USB C/USB A  
2 in 1 Audio Cable\*1



Desktop Mic Stand \*1



User Manual \*1



Warranty Card \*1

## Microphone (TX) :

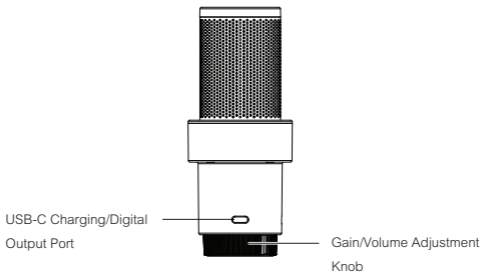
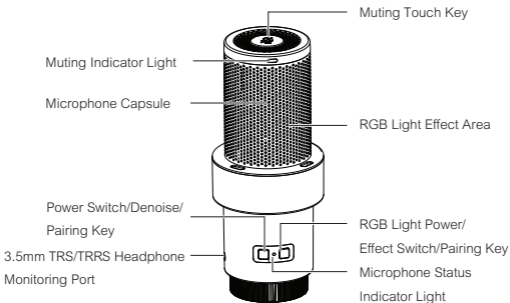

## 1.Muting Touch Key

Touch to adjust the Microphone normal pick up or muting status.

## 2.Muting Indicator Light

Red light keeps on when muting is on, no light will on when muting is off.

## 3.Microphone Capsule

## 4.RGB Light Effect Area

## 5.Power Switch/Denoise/Pairing Key

Long press to turn the power on / off; short press to turn denoise on/off.

## 6.RGB Light Power/Effect Switch/Pairing Key

Long press to turn light power on/ off;short press to switch breathing light/dynamic gradient/ audio dynamics three kinds of light effects.



Long press the two pairing keys above to enter pairing status, at this time the Microphone Status Indicator Light blinks blue light fast.

## 7.Microphone Status Indicator Light

Unpair	Blue light blinks slowly
Pairing	Blue light blinks fast
Paired	Blue light keeps on
Denoise	Green light keeps on
Turn off and charging	Red light keeps on
Fully charging	Blue light keeps on

### 8.3.5mm TRS/TRRS Headphone Monitoring Port

Plug in 3.5mm TRS/TRRS headphones for real-time monitoring

### 9.USB-C Charging/Digital Output Port

Charging the Mic with a rechargeable battery/DC power supply via the 2 in 1 charging/output cable, or connect to devices for audio output

### 10.Gain/Volume Adjustment Knob

Taking the orange scale in the center as a standard, rotate left to decrease the mic gain and headphone monitoring volume; rotate right to increase the mic gain and headphone monitoring volume.

Receiver (RX) :

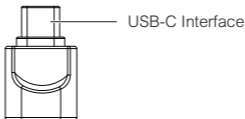



### Install the Boom Arm:

1. Clamp the stand base of boom arm to the desktop or other objects, then tighten the fixing clip clockwise.



2. Connect the boom arm to the stand base, adjust the angle of boom arm through the fixing clip on stand base.

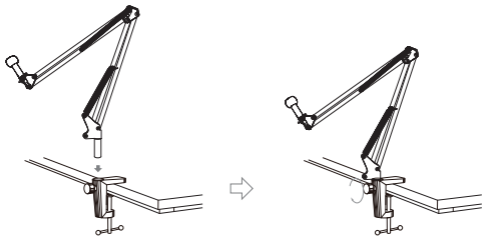

3. Connect the mic shock-mount to the boom arm, then tighten the fixing clockwise.

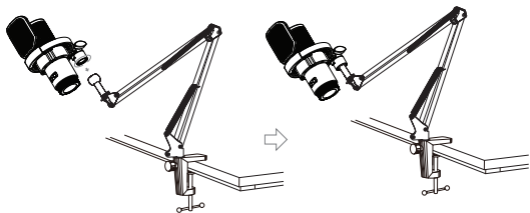

4. Adjust and fix the mic through the locking screw on boom arm.

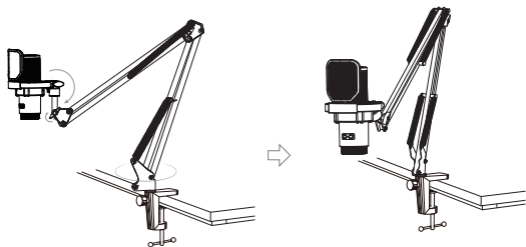

## Install the Desktop Mic Stand:

1. Connect the threaded hole of the shock-mount to the thread of the desktop mic stand, turn clockwise to tighten and fix



2. Install the pop filter on the shock-mount

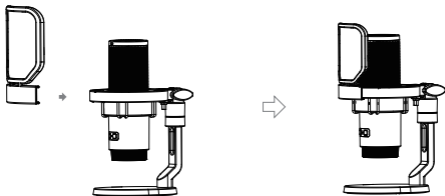

3. Adjust and fix the shock-mount and mic through the locking screw



## Wired Mode

Connected the mic with smartphone/computer through 2 in 1 audio cable and related audio adapter cable/adapter; Choose whether to monitor according to your needs.

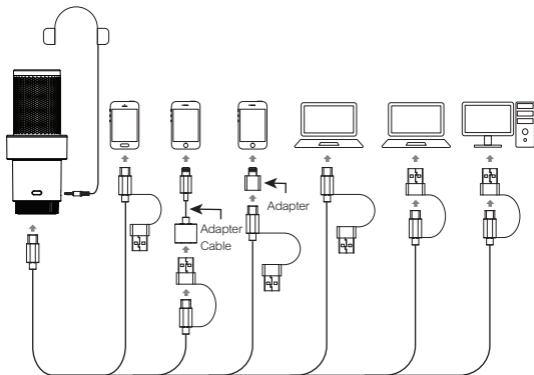

1. Please purchase USB-Lightning Adapter Cables/Adapters support OTG function by yourself when connected with lightning port devices.
2. The microphone will automatically switch on when connected with a device, and it will automatically turn off after 10 minutes if disconnected from a device.

## Wireless Mode

**Pairing (the mic and receiver are paired by default at the factory. If you need to re-pair in special circumstances, please refer to the following pairing method)**

Long press the two pairing keys of mic to enter pairing status, and connect the receiver to a device to enter wireless state. At this time, the Microphone Status Indicator Light is flashing blue. After successful pairing, the Microphone Status Indicator Light keeps on blue.



When the mic fails to pair with the receiver, please switch off the mic and then refer to the above steps to pair again.

## Usage

When connected with a device, please refer to the following connection method:

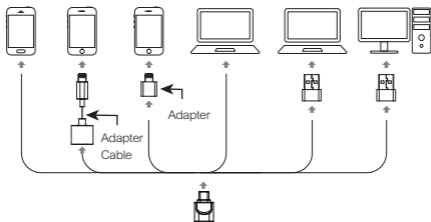

1. Please purchase USB-Lightning Adapter Cables/Adapters support OTG function by yourself when connected to lightning port devices.
2. Please be sure the OTG function of smartphone is turned on first, otherwise the pairing will not be successful.
3. The wired and wireless mode can be used in syn.

## Specifications

Transmitting Power	+10dBm
Reception Sensitivity	-97dBm
Antenna Type	Ceramic Antenna
Wireless Delay	<20ms
Directivity	Cardioid
Microphone Sensivity	-35dB±2dB
Frequency Range	20Hz ~ 20kHz
Maximum SPL	105dB (@ 1% THD)
Signal / Noise	72dB SPL(A-weighted,as per IEC651)
Equivalent Noise	22dB SPL(A-weighted,as per IEC651)
Dynamic Range	83dB SPL(A-weighted,as per IEC651)
Sampling Rate	48kHz
Bit Depth	Microphone Recording: 24-bit Headphone Monitoring: 16-bit
Output Interface	USB-C
Monitoring Port	3.5mm TRS/TRRS
Battery Type	Lithium Polymer 1000mAh 3.7V
Standby Time	RGB off: 50 hours; RGB on: 20 hours;
Net Weight	Microphone Body: 140g RX: 2.6g;
Dimension	Microphone Body: Φ64.5 x L154.2mm RX: 15.5 x 7.0 x 25.7mm
Operating Temperature	0°C~+50°C
Storage Temperature	-20°C~+60°C





Website: [comica-audio.com](http://comica-audio.com)

Facebook: Comica Audio Tech Global

Instagram: Comica Audio

YouTube: Comica Audio

COMICA is a registered trademark owned by Commlite Tech Co.,Ltd

Email: [support@comica-audio.com](mailto:support@comica-audio.com)



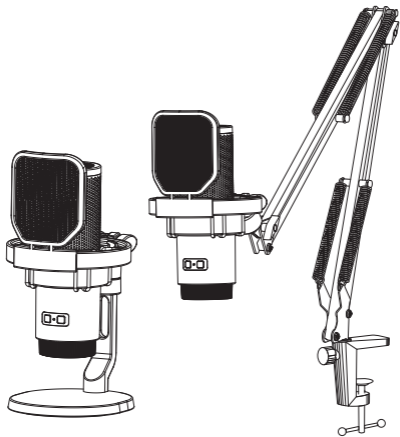

享听Uni Pro  
RGB心型电容无线USB麦克风

产品使用说明书



感谢您购买科唛享听Uni Pro

### 产品主要功能

- 首创棚麦集成无线射频模块，有线无线双模式
- 48kHz/24bit录音，专业棚级音质
- 增益调节，实时监听，一键降噪及静音
- RGB动态灯效，3种灯效模式选择
- USB-C数字输出，通用于手机、电脑
- 独特减震架及金属防喷罩，有效滤除噪音
- 可调节悬臂支架，承重高达1.5kg—Uni Pro(A)
- 搭配圆盘支架，可灵活延展及组合—Uni Pro(D)

## 注意事项

- ⚠ 为获得更好的录音效果，请将麦克风的正面对准音源
- ⚠ 请勿将本设备放置在热源或干扰源附近使用，如散热器、烤箱、冰箱、空调等
- ⚠ 本产品属于精密仪器类产品，请避免使用时掉落、碰撞或重击
- ⚠ 不要在雨中或潮湿的环境中使用该设备，否则会有短路的危险
- ⚠ 请在干燥环境中对该产品进行保存
- ⚠ 当麦克风连接电脑使用时，请打开声音设置界面选择“Comica\_EJoy Uni Pro TX”为输出和输入设备；当接收器连接电脑使用时，请打开声音设置界面选择“Comica\_EJoy Uni Pro RX”为输出和输入设备

麦克风连接电脑使用时：



接收器连接电脑使用时：



- ⚠ 若连接电脑输入时声音偏大，可以调节电脑“麦克风属性-级别”降低增益，下面以Windows电脑为例

麦克风连接电脑使用时：



接收器连接电脑使用时：

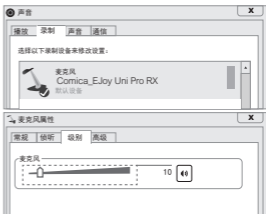

享听Uni Pro(A):

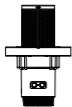

麦克风 (TX) \*1



接收器 (RX) \*1



防喷罩 \*1



USB C-USB C/USB A  
二合一音频连接线 \*1



悬臂支架 \*1



魔术贴 \*5



说明书 \*1



保修卡 \*1

享听Uni Pro(D):

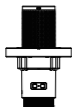

麦克风 (TX) \*1



接收器 (RX) \*1



防喷罩 \*1



USB C-USB C/USB A  
二合一音频连接线 \*1



圆盘支架 \*1



说明书 \*1



保修卡 \*1

麦克风 (TX) :

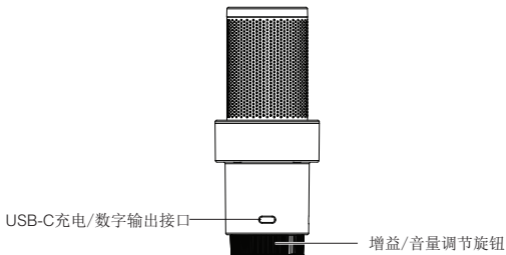
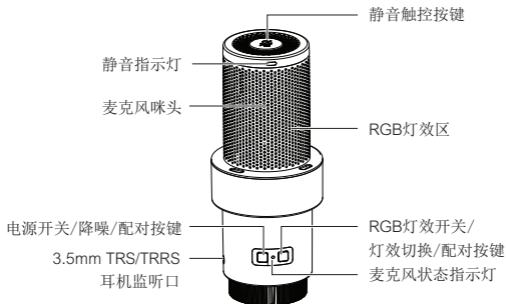

## 1. 静音触控按键

轻触切换麦克风正常拾音或静音状态

## 2. 静音指示灯

静音开启后红灯长亮，静音关闭后指示灯熄灭

## 3. 麦克风味头

## 4. RGB灯效区

## 5. 电源开关/降噪/配对按键

长按开机或关机；短按开启或关闭降噪功能

## 6. RGB灯效开关/灯效切换/配对按键

长按开启或关闭灯光效果；短按切换呼吸灯/动态渐变/音频动态三种灯光效果

 同时长按以上两个配对按键进入配对状态，此时麦克风状态指示灯蓝灯快闪

## 7. 麦克风状态指示灯

未配对	蓝灯慢闪
配对中	蓝灯快闪
配对成功	蓝灯长亮
降噪开启	绿灯长亮
关机时充电	红灯长亮
关机时充满	蓝灯长亮

## 8. 3.5mm TRS/TRRS耳机监听口

可插入3.5mmTRS/TRRS耳机进行实时监听

## 9. USB-C充电/数字输出接口

可通过二合一充电/输出连接线连接充电宝/DC电源进行充电，或连接设备输出音频

## 10. 增益/音量调节旋钮

以中间橙色刻度线为标准，往左旋转减小麦克风增益及耳机监听音量；往右旋转增大麦克风增益及耳机监听音量

接收器 (RX)：

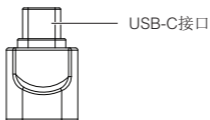



### 安装悬臂支架:

1. 将悬臂支架底座的固定夹夹在桌面或其他物体上，顺时针拧紧固定



2. 将固定夹与悬臂支架相连，通过底座上的固定螺丝钮来调整支架的角度

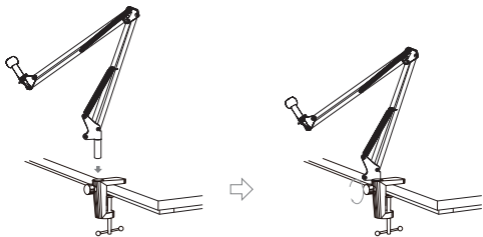

3. 将麦克风减震架与悬臂支架相连，顺时针旋转拧紧固定

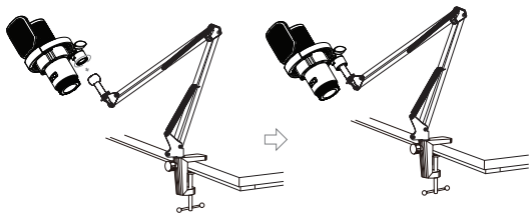

4. 通过悬臂支架上的锁紧螺杆来调整和固定麦克风的位置

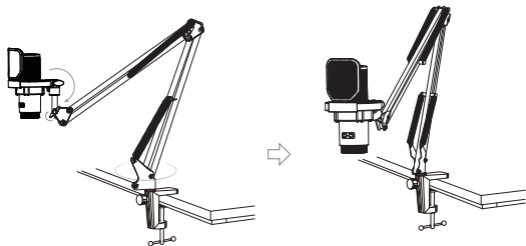

## 安装圆盘支架：

1. 将减震架的螺纹孔与圆盘支架的螺纹相连，顺时针旋转拧紧固定。



2. 将防喷罩安装在减震架上

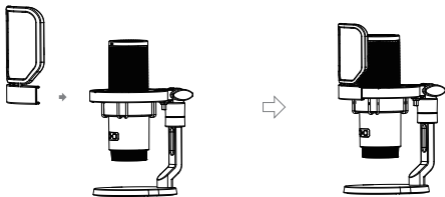

3. 通过减震架上的锁紧螺杆来调整并固定减震架与麦克风的位置

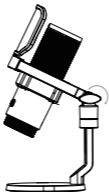

## 有线模式

通过二合一充电/输出连接线和相关音频转接线/转接头连接麦克风和手机/电脑，根据个人需求选择是否监听

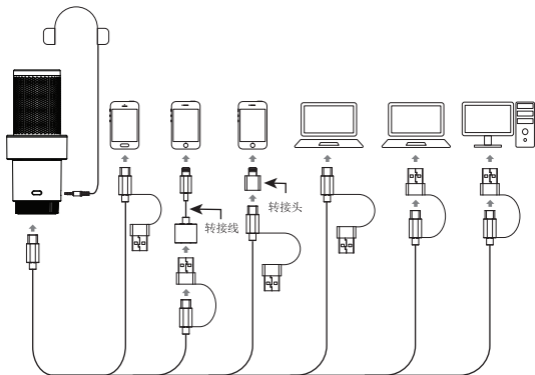

1. 搭配Lightning接口设备时，请自行购买支持OTG功能的USB-Lightning转接线/转接头
2. 麦克风连接设备后会自动开机；断开设备10分钟未使用会自动关机

## 无线模式

**配对**（出厂时麦克风与接收器默认配对，如遇特殊情况需重新配对可参考以下配对方法）

同时长按麦克风的两个配对按键进入配对状态，将接收器连接设备进入无线状态；此时麦克风状态指示灯蓝灯快闪；配对成功后麦克风状态指示灯蓝灯长亮



 当麦克风与接收器配对失败时，请将麦克风关机，然后参照上述步骤重新进行配对

## 使用

当接收器连接设备，请参考以下连接方式：

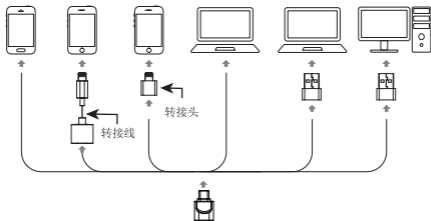

-  1. 搭配Lightning接口设备时，请自行购买支持OTG功能的USB-Lightning转接线/转接头
2. 请先确认已开启手机OTG功能，否则会出现配对失败的情况
3. 有线模式和无线模式可同时使用

## 规格参数

发射功率	+10dBm
接收灵敏度	-97dBm
天线类型	陶瓷天线
无线延迟	<20ms
指向性	心型指向
咪头灵敏度	-35dB±2dB
频率范围	20Hz ~ 20kHz
最大声压级	105dB (@ 1% THD)
信噪比	72dB SPL(A-weighted,as per IEC651)
等效噪声	22dB SPL(A-weighted,as per IEC651)
动态范围	83dB SPL(A-weighted,as per IEC651)
采样率	48kHz
位深	麦克风录音：24-bit      耳机监听：16-bit
输出接口	USB-C
监听接口	3.5mm TRS/TRRS
电池类型	锂聚合物 1000mAh 3.7V
续航时间	关闭RGB：50小时      开启RGB：20小时
产品重量	麦克风主体：140g      接收器：2.6g
产品尺寸	麦克风主体：Φ64.5 x L154.2mm 接收器：15.5 x 7.0 x 25.7mm
工作温度	0℃~+50℃
储存温度	-20℃~+60℃





扫二维码关注  
科唛官方公众号



COMICA科唛



COMICA科唛



COMICA科唛



COMICA科唛

邮箱: [support@comica-audio.com](mailto:support@comica-audio.com)

电话: 400-8303-981

网址: [comica-audio.com](http://comica-audio.com)

版权及科唛商标归味莱科技有限公司所有